

\$407,722 - 4690 W 40th Ave, Kennewick

MLS® #223781

\$407,722

Bedroom, Bathroom,
Land on 1.04 Acres

NONE/NA, Kennewick, WA

Commercial lot in one of the fastest growing areas in South East Washington. Located just North of the i-82/HWY 395 interchange

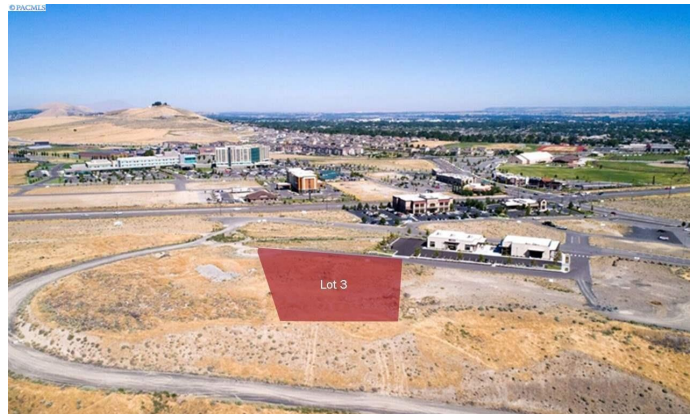

Essential Information

MLS® #	223781
Price	\$407,722
Acres	1.04
Type	Land
Sub-Type	Commercial
Status	Active

Community Information

Address	4690 W 40th Ave
Area	Benton
Subdivision	NONE/NA
City	Kennewick
State	WA
Zip Code	99338

Additional Information

Days on Market	916
Zoning	COMMCL GENERAL

Listing Details

Listing Office	Professional Realty Services
----------------	------------------------------

The data relating to real estate for sale on this website comes in part from the Tri Cities Association of REALTORS®. The information being provided is for consumers' personal, non-commercial use and may not be used for any purpose other than to identify prospective properties consumers may be interested in purchasing.

Listing information last updated on October 20th, 2021 at 10:32am PDT